



WOOD STOVE

STEEL CASE 60/70

STONE CASE 60/70

STONE CASE CUSTOM 60/70

PART 2 - CLADDING ASSEMBLY

Translation of the original instructions

MCZ

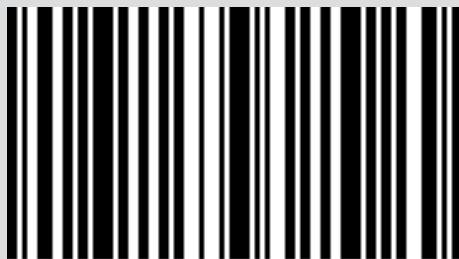

8902419700

TABLE OF CONTENTS

TABLE OF CONTENTS II

13-UNPACKING3

14-CLADDING CONTENT5

15-CUSTOM CLADDING PREPARATION7

16-CLADDING ASSEMBLY PHASES12

17-CHARACTERISTICS AND CLEANING28

13-UNPACKING



IMPORTANT!

The product must be installed and connected to the smoke duct exclusively by a specialised technician, so that every local or national regulation is complied with. Installation must nevertheless be carried out in accordance with regulation UNI 10683.

When you unwrap the product, make sure that every part is in perfect working order and check for any damage due to transport. Any damage must be immediately reported to the carrier or dealer.

If the product is installed in an area difficult to access, its weight can be reduced by removing the internal elements of the firebox, every element should then be put correctly back in place and this operation should be carried out exclusively by specialised personnel.

The producer will not be held liable if the above warning is not observed.

PREPARATION AND UNPACKING

Open the packaging, remove the product from the pallet and place it in the chosen position, ensuring it complies with the specifications. **It is advisable to open the cardboard at the top and remove the parts such as sides/tops/frames resting on the support to prevent them from falling off.**



The product must always be handled UPRIGHT only by trucks. Do not drag the product as this might damage the supporting feet.

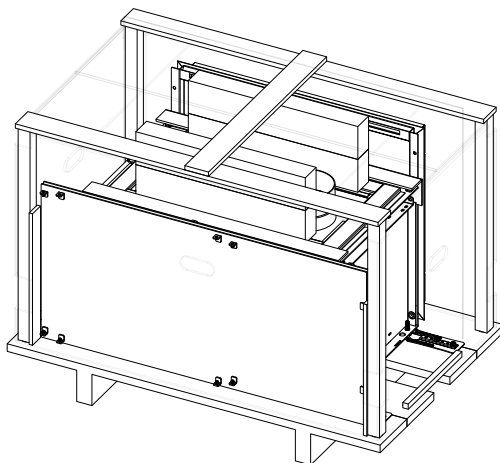

STEEL CASE 70 CLADDING PACKAGING

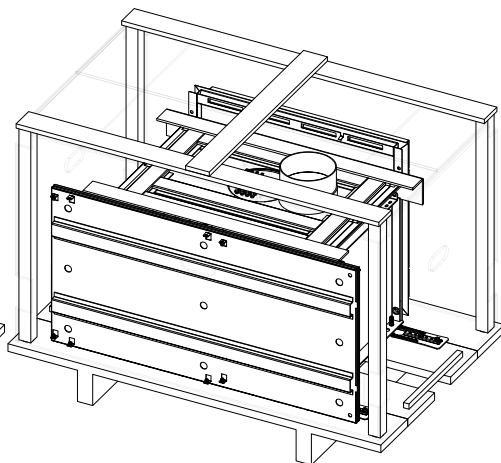

STONE CASE 60 CLADDING PACKAGING



Caution! The package with the QBOX 60/70 machine is placed next to the cladding package. For the QBOX, follow the instructions in the product manual.

Products must always be handled with care. If possible, unpack the product near the place of installation.

The packaging materials are neither toxic nor harmful, therefore no particular disposal measures are required.

The end user is responsible for product storage, disposal or possible recycling in compliance with the relative applicable laws in force. Before assembling the product, ensure you have removed all items that might burn (polystyrene, instructions and various stickers).

13-UNPACKING

To remove the product from the pallet, you must remove the two screws “u” and plate “s” from the product’s foot. There are four brackets “s”.

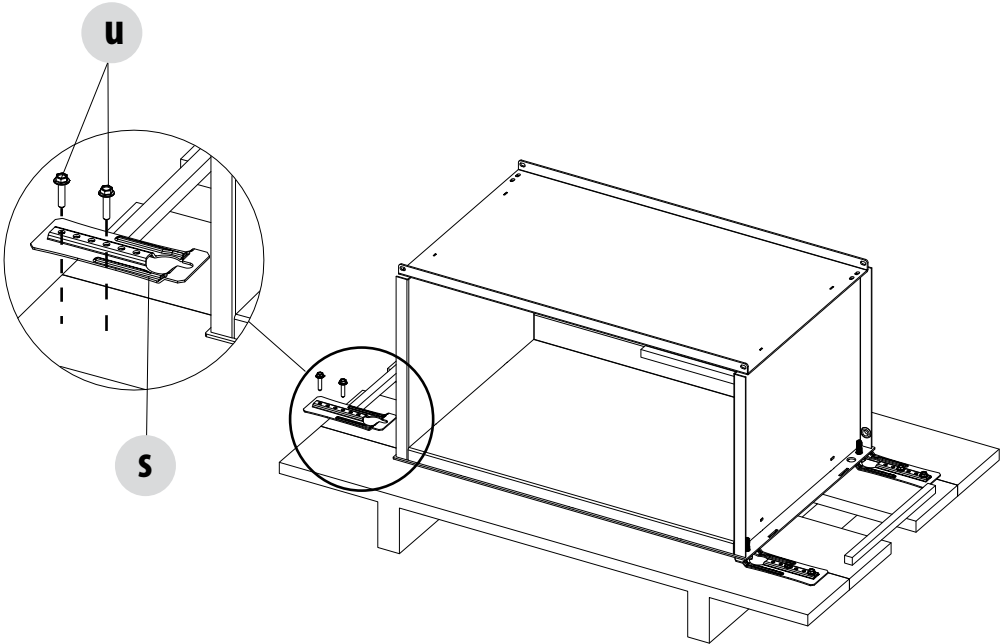

14-CLADDING CONTENT

STEEL CASE 60/ STEEL CASE 70 CLADDING

Wood-burning stove with lower wood compartment made of black painted steel.
The stove can also be installed not flush with the wall and is available with QBOX 60 WOOD and QBOX 70 WOOD.

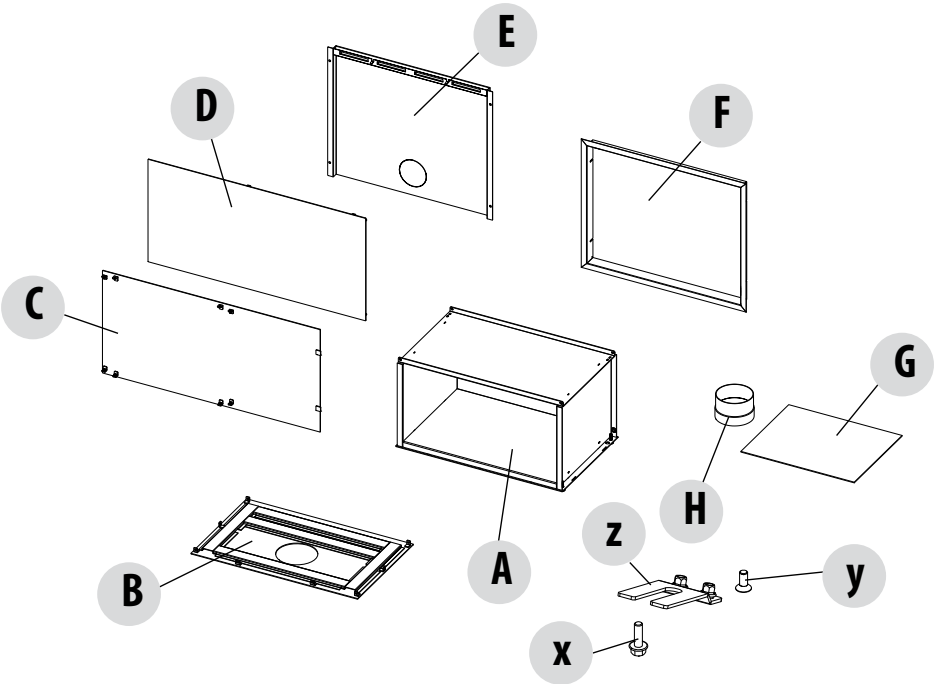

POS.	DESCRIPTION	QUANTITY	POS.	DESCRIPTION	QUANTITY
A	QBOX SUPPORT	1	G	INSULATING PANEL	1
B	TOP	1	H	SLEEVE	1
C	RIGHT SIDE PANEL	1	x	MSX16 HEX HEAD SCREW	12
D	LEFT SIDE PANEL	1	y	MSX12 SCREW	4
E	BACK	1	z	FOOT FASTENING BRACKET	2
F	FRAME	1			

14-CLADDING CONTENT

STONE CASE 60/70 CLADDING

Wood-burning stove with lower wood compartment in the “Materia Tortora”, “Materia Piombo” or “Materia n Corten” finish. In addition, Stone Case can also be “Custom” with cladding fully customised by the customer.

In the case of “Materia” claddings, the side panels are already ready for assembly, while in the “Custom” version, a fastening and resting time of the material chosen (by the customer) is required before proceeding with assembly operations.

The stove can also be installed not flush with the wall and is available with QBOX 60 WOOD and QBOX 70 WOOD.

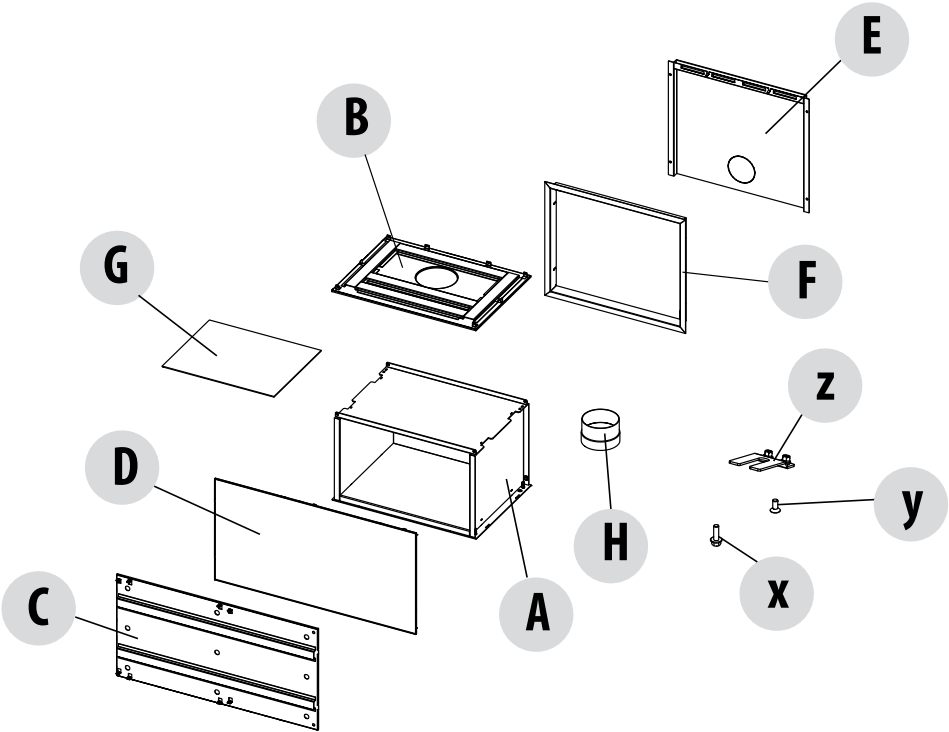

POS.	DESCRIPTION	QUANTITY	POS.	DESCRIPTION	QUANTITY
A	QBOX SUPPORT	1	G	INSULATING PANEL	1
B	TOP	1	H	SLEEVE	1
C	RIGHT SIDE PANEL	1	x	M5X16 HEX HEAD SCREW	12
D	LEFT SIDE PANEL	1	y	M5X12 SCREW	4
E	BACK	1	z	FOOT FASTENING BRACKET	2
F	FRAME	1			

15-CUSTOM CLADDING PREPARATION

STONE CASE 60/70 “CUSTOM” CLADDING

The customised stoneware cladding consists of an iron frame and a panel purchased separately by the customer.

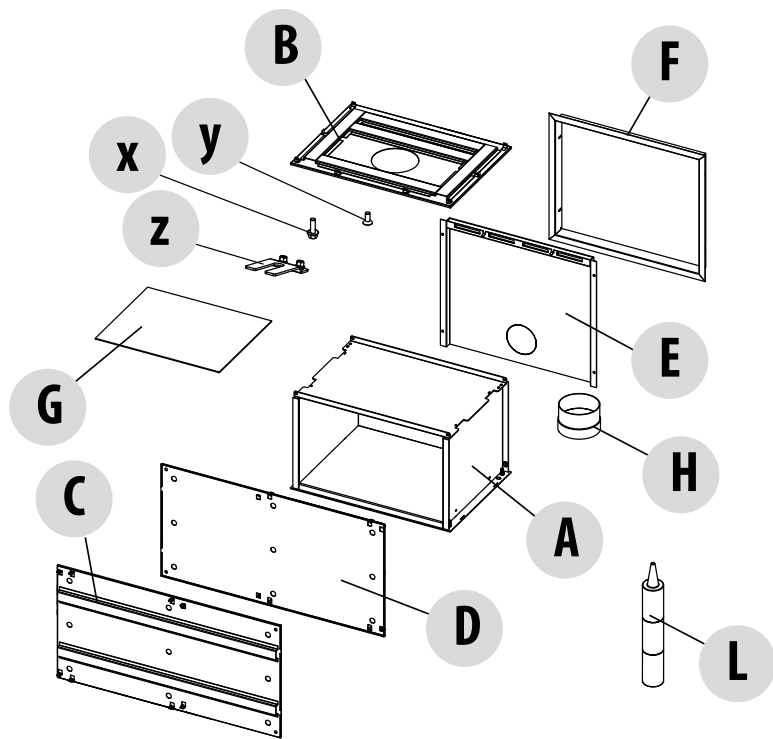

POS.	DESCRIPTION	QUANTITY	POS.	DESCRIPTION	QUANTITY
A	QBOX SUPPORT	1	G	INSULATING PANEL	1
B	TOP	1	H	SLEEVE	1
C	RIGHT SIDE PANEL	1	x	MSX16 HEX HEAD SCREW	12
D	LEFT SIDE PANEL	1	y	MSX12 SCREW	4
E	BACK	1	z	FOOT FASTENING BRACKET	2
F	FRAME	1	L	SILICONE	1

15-CUSTOM CLADDING PREPARATION

STONEWARE SLAB CUTTING MEASUREMENTS (BY CUSTOMER)

For the characteristics of the cladding to be used, see the technical data table at the end of the manual.

STONE CASE 60 TOP

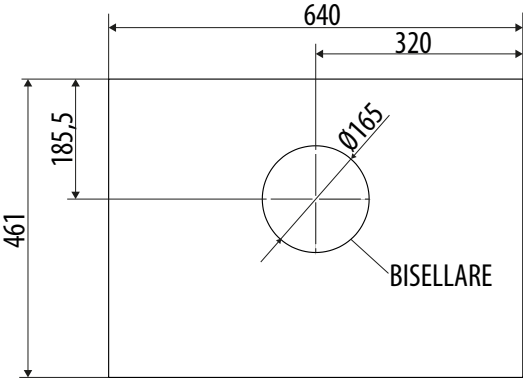

PORCELAIN STONEWARE MATERIAL THICKNESS
3.5 MM

ON THE NON-VISIBLE SURFACE APPLY BREAK-
RESISTANT GLASS FIBRE MESH

FINISHING OF EDGES THAT ARE NOT SHARP OR
POINTED

THE VISIBLE SURFACE MUST BE FREE OF
SCRATCHES, CREASE MARKS, IMPERFECTIONS
AND POSSIBLE HALOS

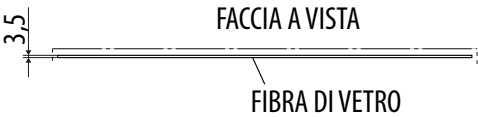

STONE CASE 70 TOP

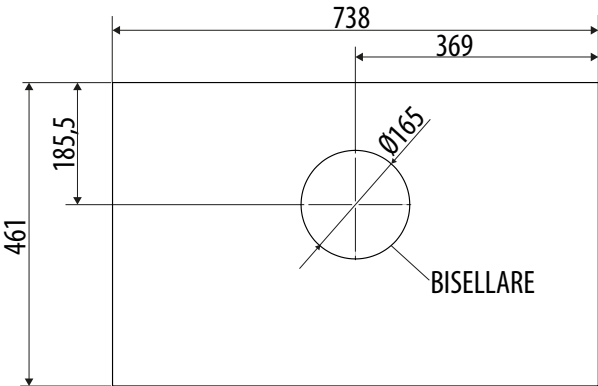

PORCELAIN STONEWARE MATERIAL THICKNESS
3.5 MM

ON THE NON-VISIBLE SURFACE APPLY BREAK-
RESISTANT GLASS FIBRE MESH

FINISHING OF EDGES THAT ARE NOT SHARP OR
POINTED

THE VISIBLE SURFACE MUST BE FREE OF
SCRATCHES, CREASE MARKS, IMPERFECTIONS
AND POSSIBLE HALOS

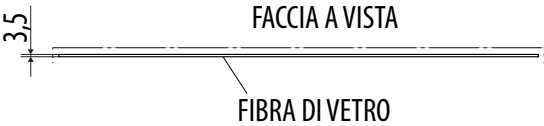

15-CUSTOM CLADDING PREPARATION

STONE CASE 60 SIDE PANEL

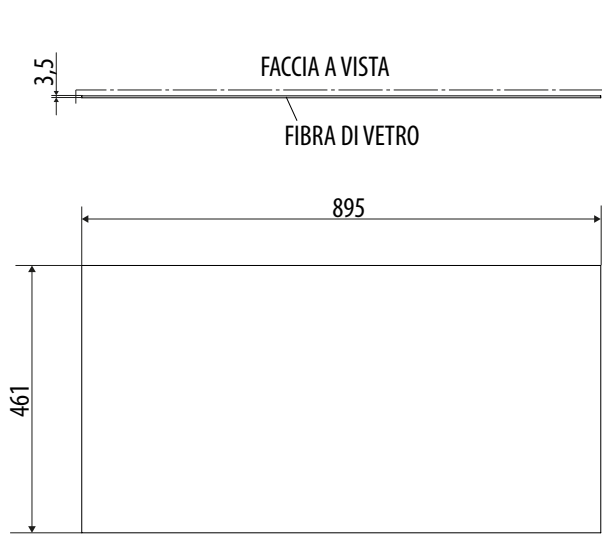

PORCELAIN STONEWARE MATERIAL THICKNESS
3.5 MM

ON THE NON-VISIBLE SURFACE APPLY BREAK-
RESISTANT GLASS FIBRE MESH

FINISHING OF EDGES THAT ARE NOT SHARP OR
POINTED

THE VISIBLE SURFACE MUST BE FREE OF
SCRATCHES, CREASE MARKS, IMPERFECTIONS
AND POSSIBLE HALOS

STONE CASE 70 SIDE PANEL



PORCELAIN STONEWARE MATERIAL THICKNESS
3.5 MM

ON THE NON-VISIBLE SURFACE APPLY BREAK-
RESISTANT GLASS FIBRE MESH

FINISHING OF EDGES THAT ARE NOT SHARP OR
POINTED

THE VISIBLE SURFACE MUST BE FREE OF
SCRATCHES, CREASE MARKS, IMPERFECTIONS
AND POSSIBLE HALOS

15-CUSTOM CLADDING PREPARATION

STONE CASE CUSTOM 60/70 TOP

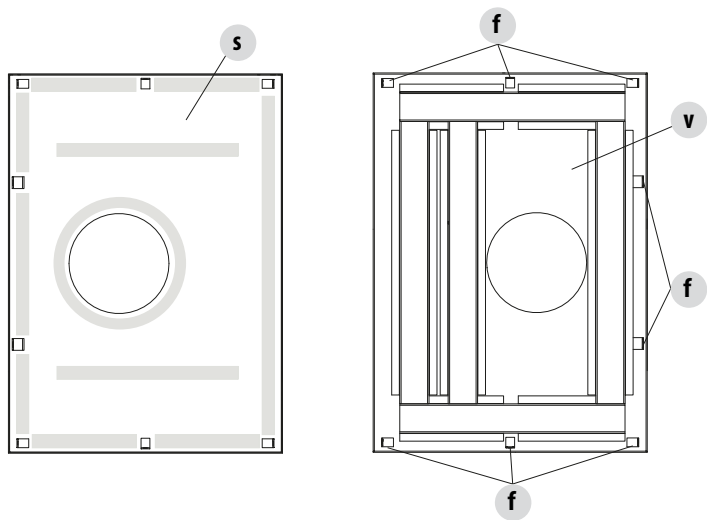

STONE CASE CUSTOM 60/70 SIDE PANELS

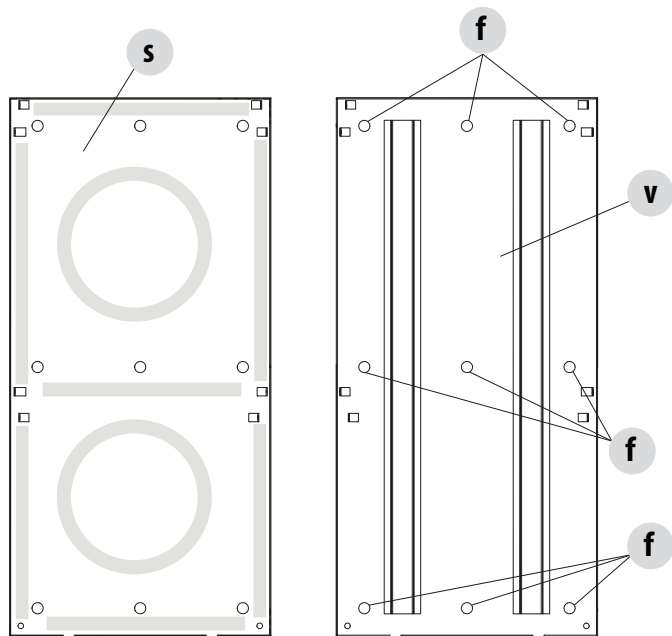

ENSURE A DISTANCE OF 10 MM FROM THE EDGE WITHOUT VISIBLE ADHESIVE ON BOTH TOP AND SIDE PANELS

s	FRAME EXTERNAL PART where the cladding is glued	f	GLUING POINTS
v	FRAME INTERNAL PART where the structure is fastened		ADHESIVE LAYOUT

15-CUSTOM CLADDING PREPARATION

To glue the cladding to the iron frame, proceed as follows:

- lay the cladding slab on a counter - CUSTOM MADE BY CUSTOMER - (the visible part of the slab towards the counter)
- distribute the adhesive (high-temperature silicone supplied) on the outside of the frame as indicated on the previous page without adhesive at the edges by approximately 10 mm
- place the outer side of the iron frame on top of the cladding slab, taking care to centre the frame and cladding
- apply pressure evenly until the glue dries (approx. 24 hours)
- proceed with the assembly of the side panels and top as per the instructions on the previous pages

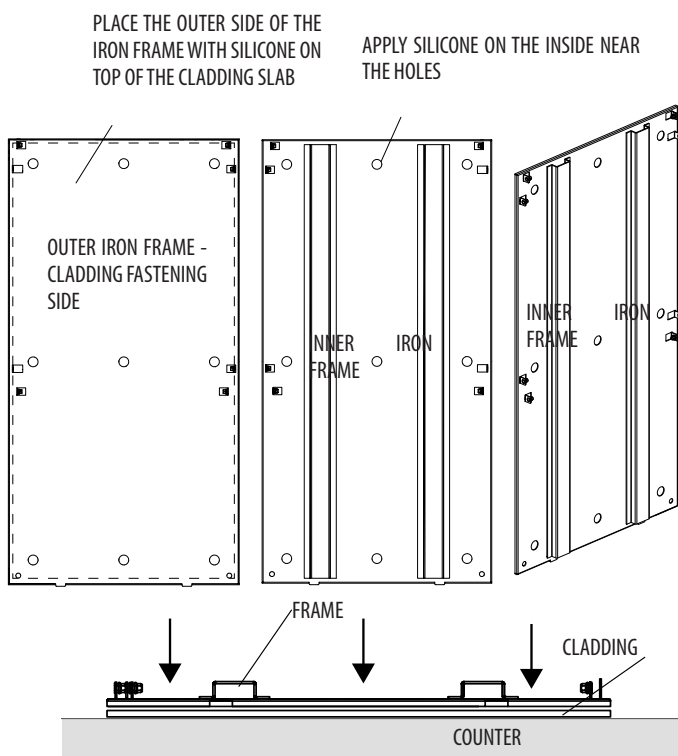

16-CLADDING ASSEMBLY PHASES

POSITIONING SUPPORT "A"

Position support "A" on the floor by adjusting the height of the foot to approx. 15 mm.



Caution! When positioning support "A", take care that the cable gland hole corresponds to the rear of the QBOX 60/70

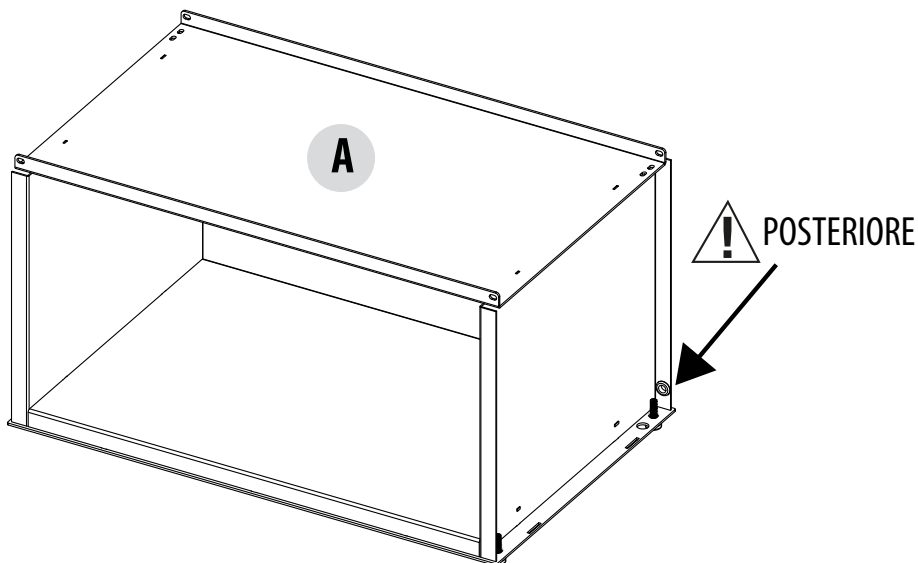

Before proceeding, check that the support is level, with a spirit level

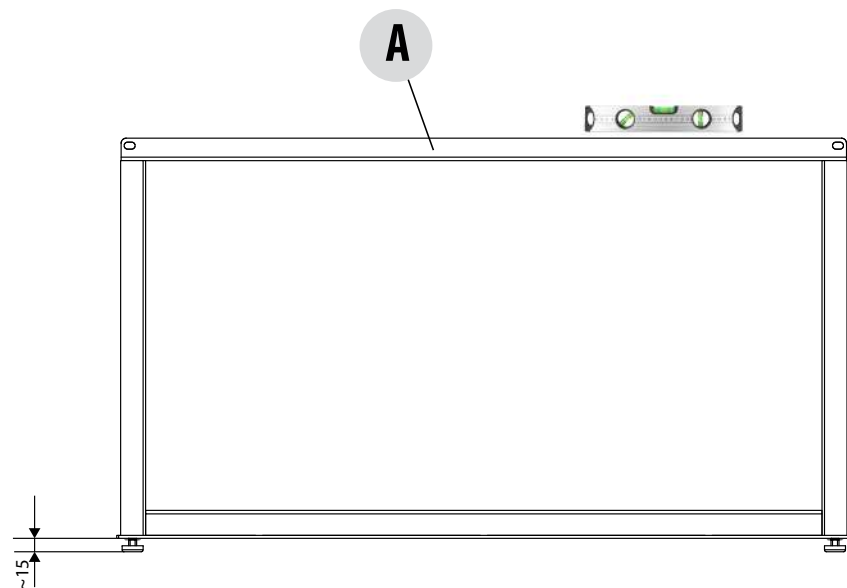

16-CLADDING ASSEMBLY PHASES

Place insulating board "G" in the centre of support "A"

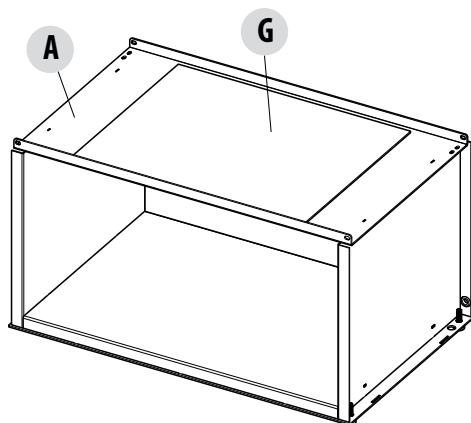
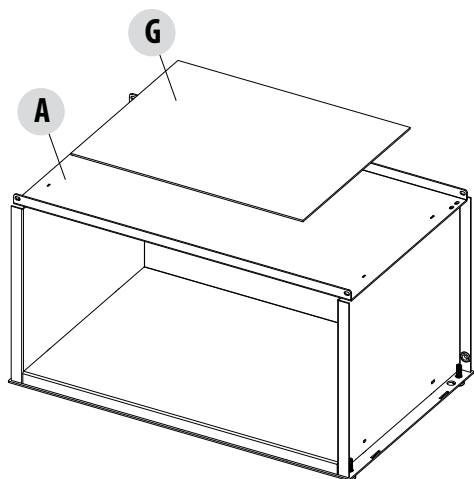

Place QBOX WOOD "S" on top of support "A" and centred on insulation panel "G"

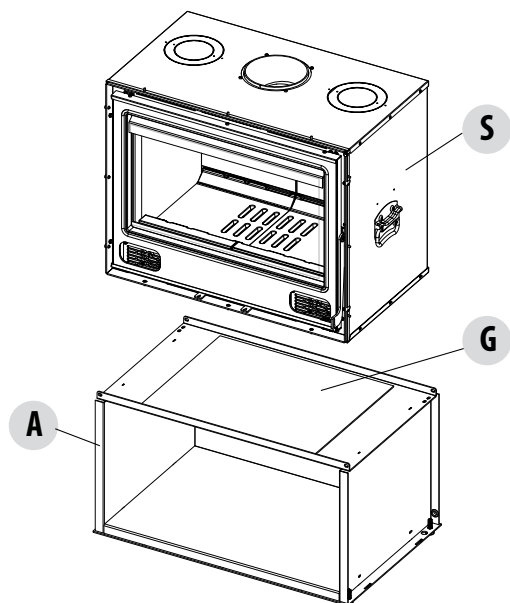

16-CLADDING ASSEMBLY PHASES

In order to position the QBOX WOOD at the correct height, the frame must be positioned so:

- Take frame "F" from the packaging

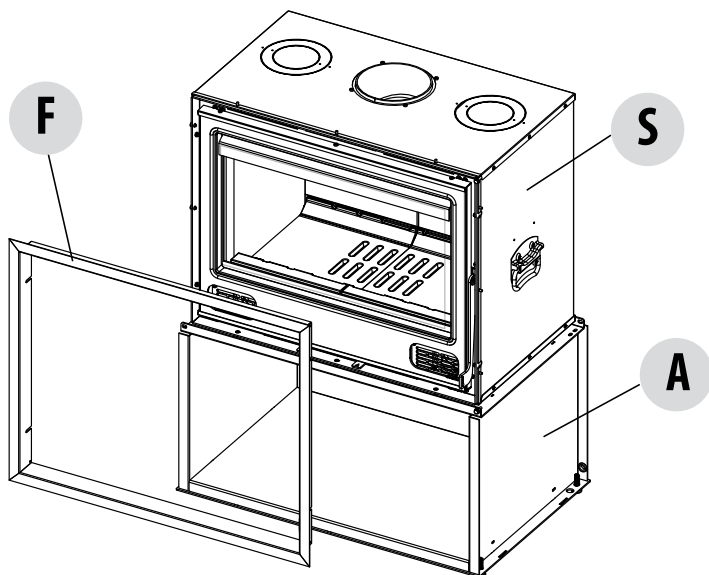

- Use the screws "u" already attached to the QBOX "S" to attach the frame "F" to the product



CAUTION! When assembling/disassembling frame "F", take care that screw "u" and the glass of the firebox door do not come into contact. Glass breakage may occur.

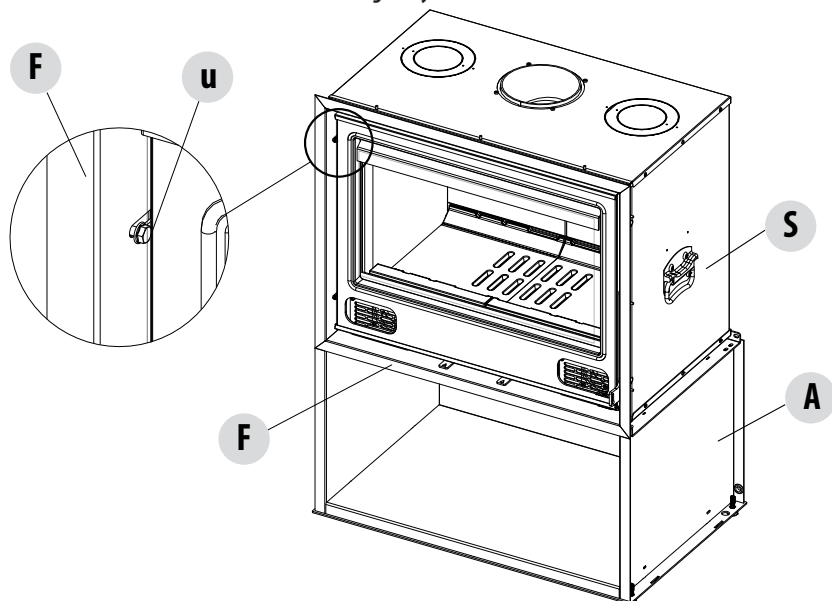

16-CLADDING ASSEMBLY PHASES

- Frame "F" must be positioned flush with the support and the QBOX feet must be adjusted so that the frame is flush with support "A"

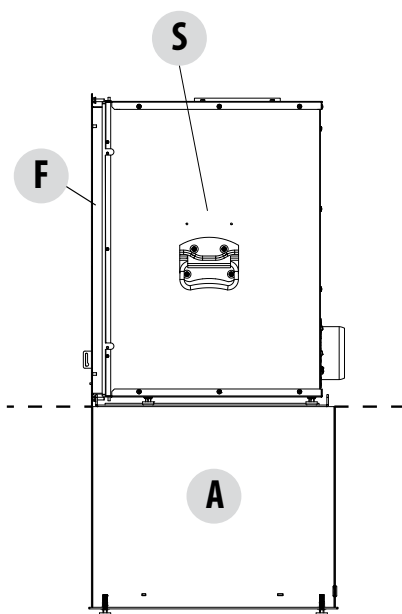
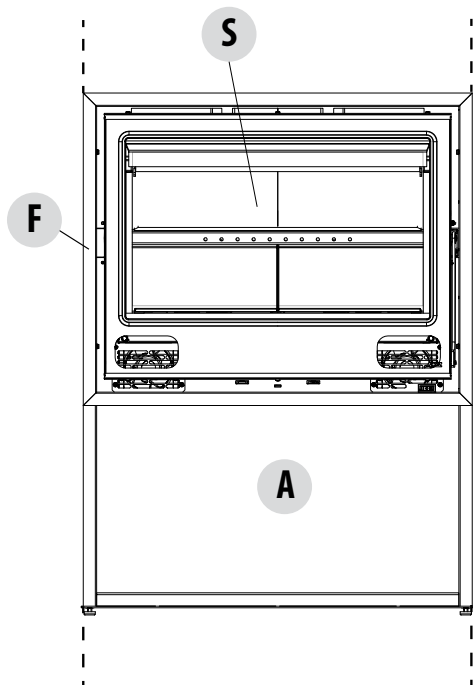
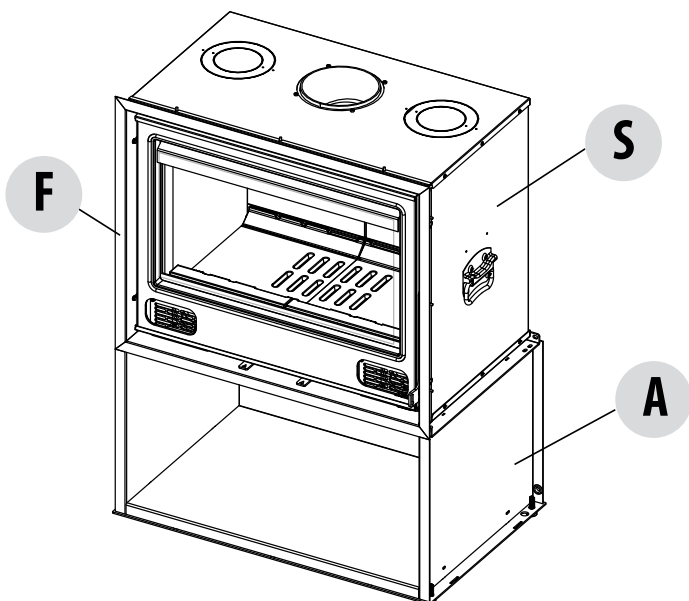

16-CLADDING ASSEMBLY PHASES

- adjust the feet so that the frame is flush with the support at approx. 15 mm

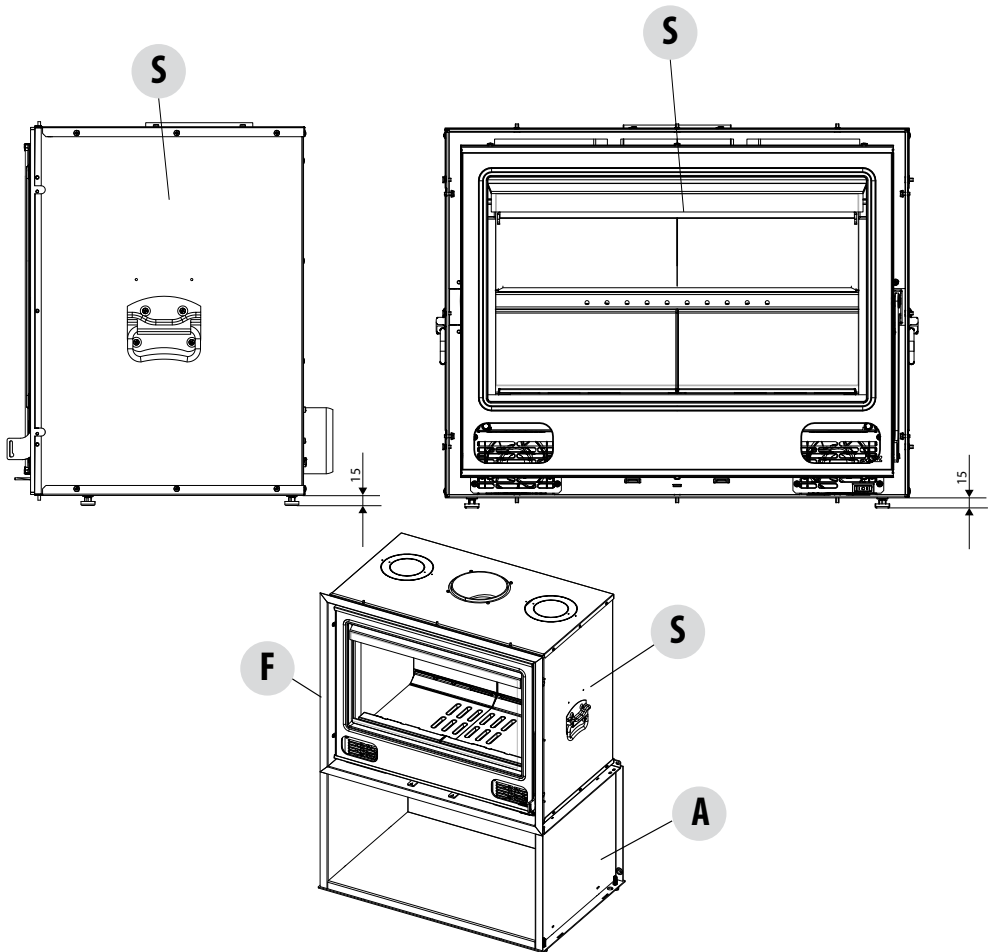

16-CLADDING ASSEMBLY PHASES

After adjusting the QBOX WOOD, remove frame "F"

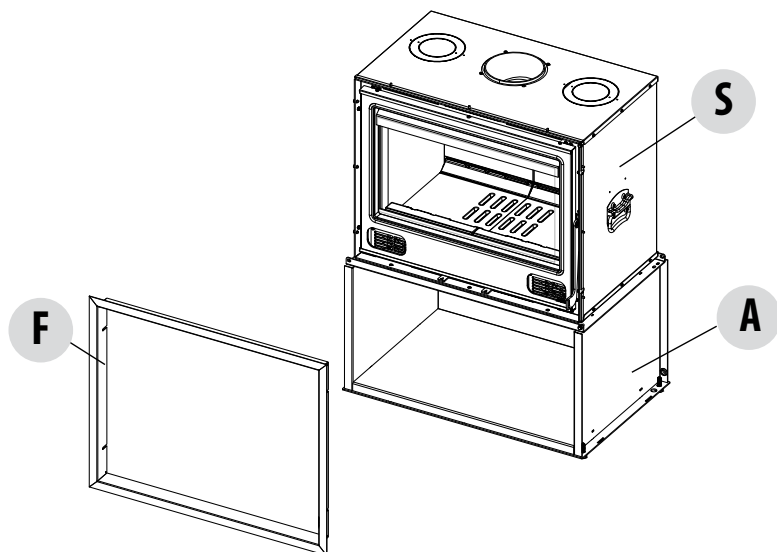

Proceed with fastening QBOX insert "S" to support "A"

- take the two "z" brackets and the two "x" screws
- slide the bracket "z" onto foot "p" of the QBOX insert "S" and fasten the bracket to support "A" by means of two screws "x" supplied with the cladding

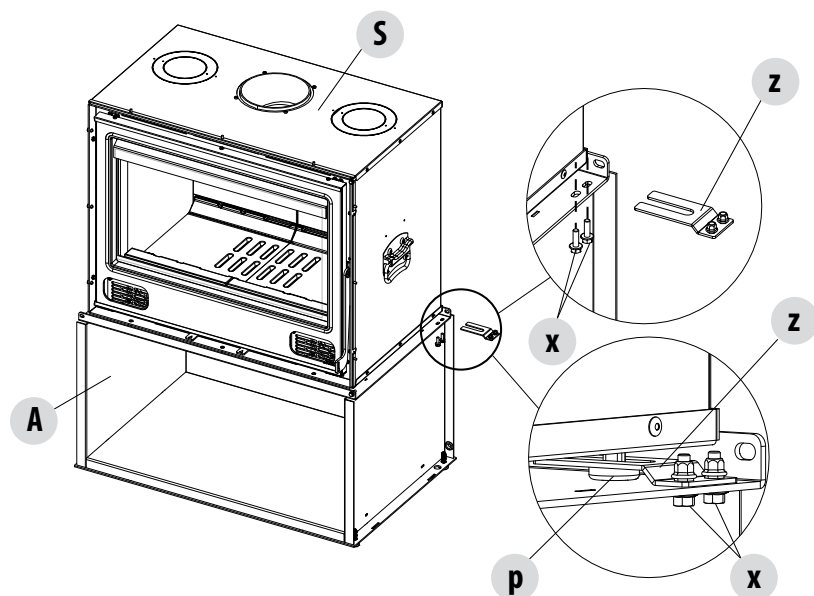

16-CLADDING ASSEMBLY PHASES

- Perform the same operation above also on the other side of the QBOX "C"

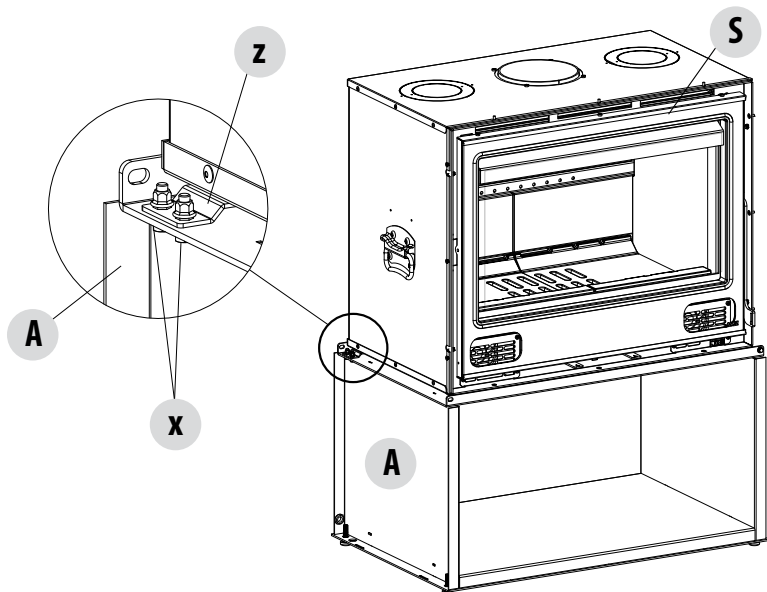

Before assembling the side panels, remove the two handles "O" by removing the two screws "j".

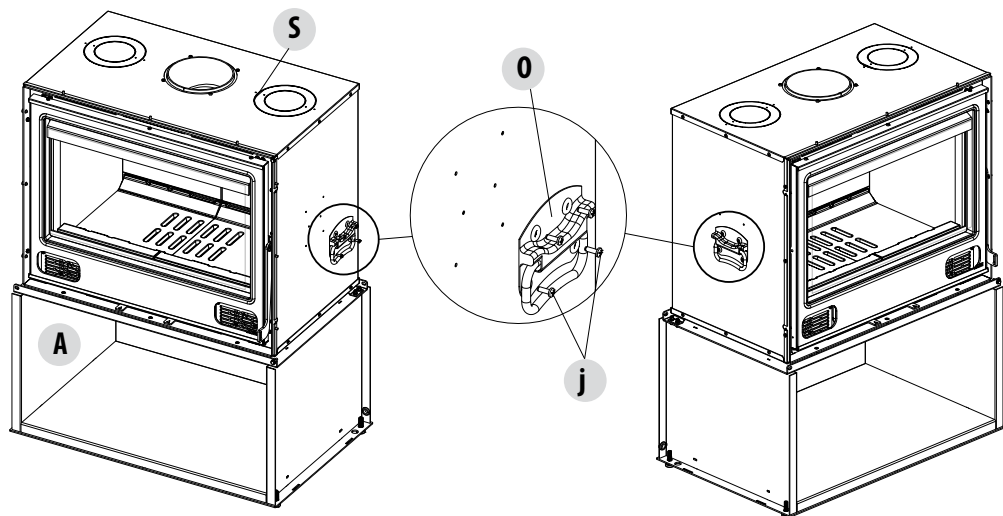

16-CLADDING ASSEMBLY PHASES

Feed the power cables through the cable gland indicated by the arrow.



CAUTION! The cable gland can also be moved to the other hole at the base of the support. It is also possible to run cables on both the right and left side of the support.

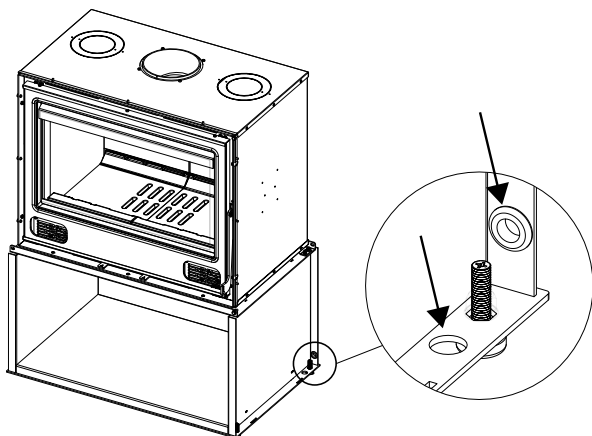

FITTING THE SIDE PANELS "C" / "D"

Take the right side panel "C" and 2 screws "x"

- Insert the "V" hooks on side panel "C" into the "U" holes on support "A"



Caution! Before fixing the panel, make sure that the front of the panel (towards the firebox door) has the "m" brackets for fixing the frame. This detail makes it possible to distinguish the right panel from the left.

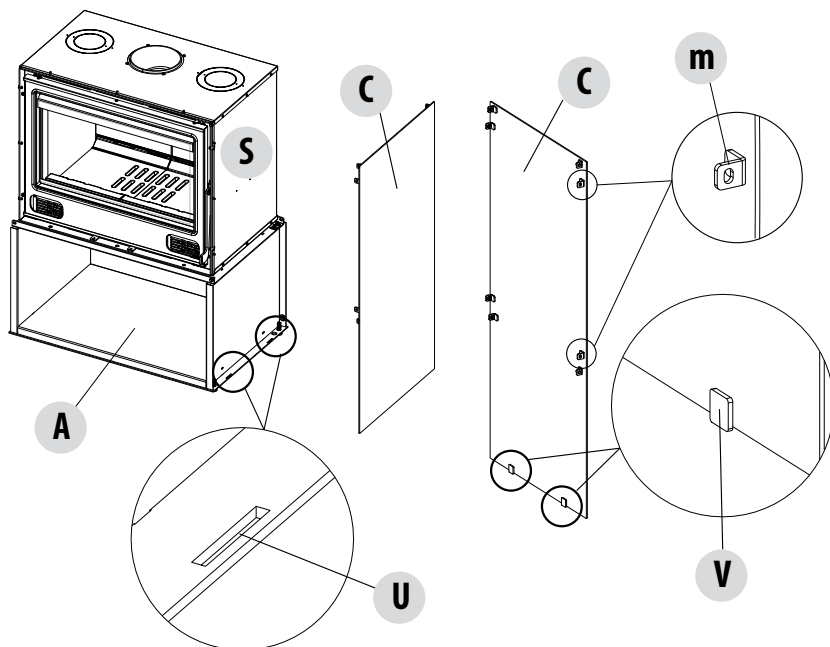

16-CLADDING ASSEMBLY PHASES

Fasten side panel "C" at the front using screw "x".

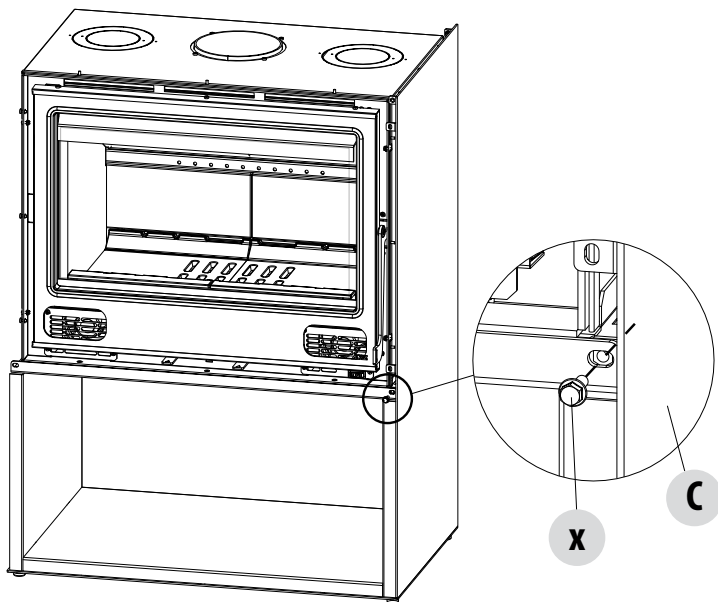

At the rear, fasten side panel "C" with screw "x"

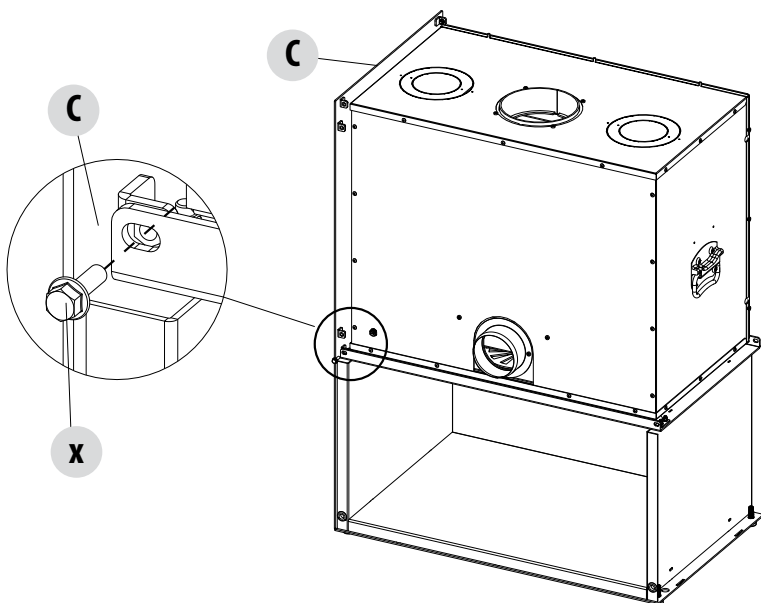

16-CLADDING ASSEMBLY PHASES

- Proceed in the same way with the left side panel "D"

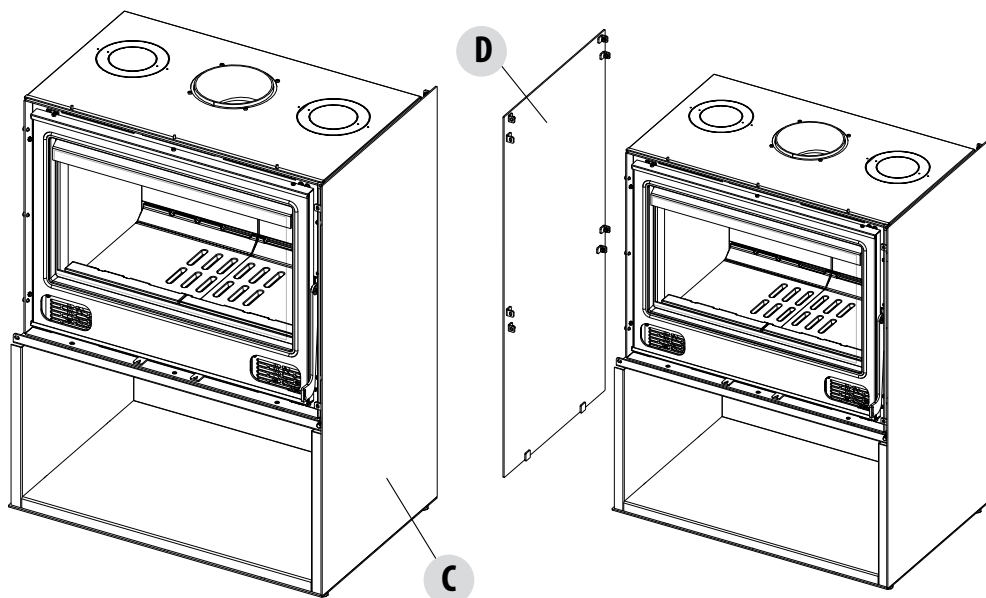

ASSEMBLING TOP B

- take top "B" and place it on top of the structure

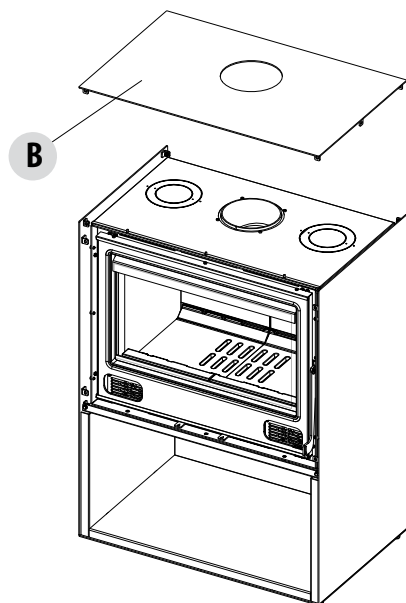

16-CLADDING ASSEMBLY PHASES

- fix top "B" at the front using two screws "x"

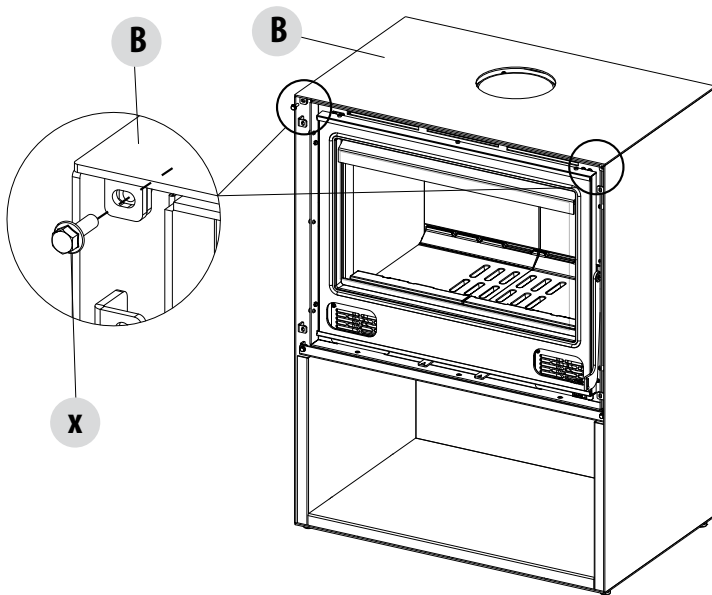

- fix top "B" at the rear using two screws "x"

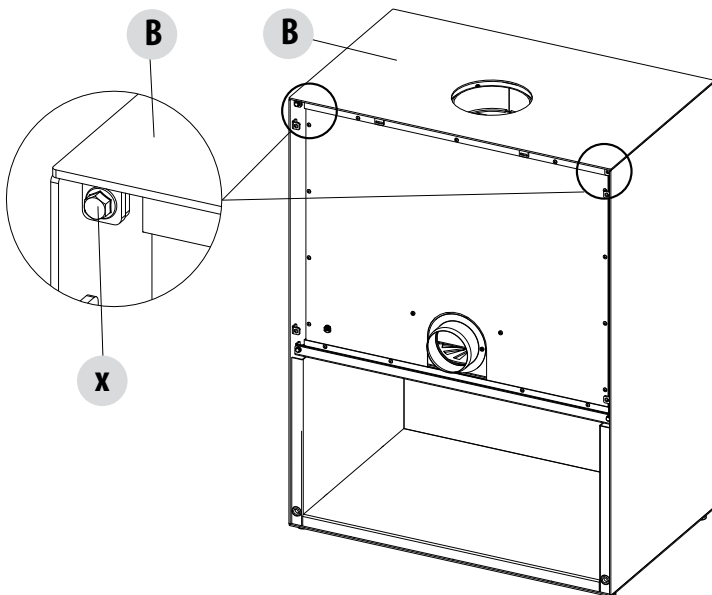

16-CLADDING ASSEMBLY PHASES

ASSEMBLING BACK E



Caution! If the product is installed close to a wall, it is possible to draw air for combustion outside by connecting the flange on the rear of the QBOX to a hose. If this is done, it is necessary to remove the knockout hole on the back "E" of the cladding in order to pass the pipe to be ducted to the outside. If this is not necessary before installing the back "E", remove the flange.

For all assembly instructions for QBOX WOOD, please refer to the instructions inside the machine.

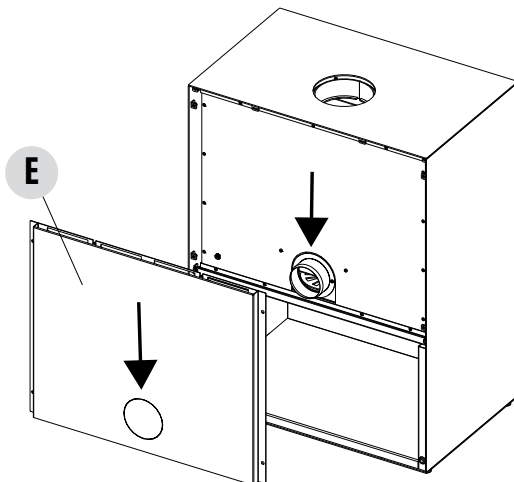

16-CLADDING ASSEMBLY PHASES

Take back "E" and 4 screws "y" from the packaging.

- Insert the hooks "g" on the back "E" into the slots "f" on the top "B"

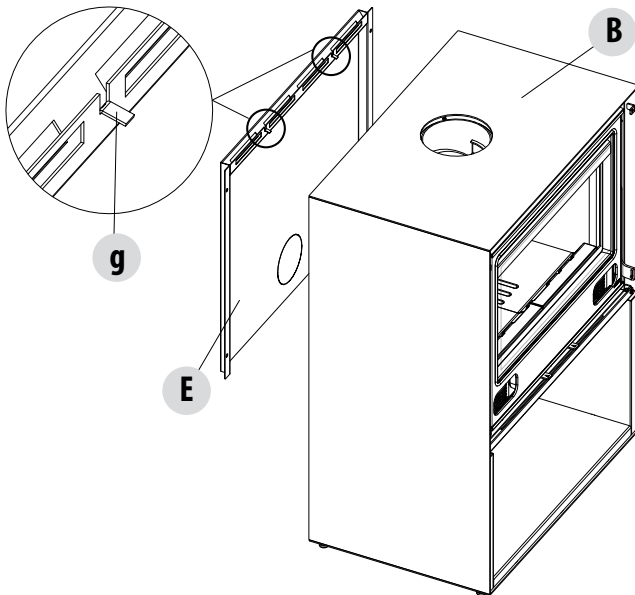
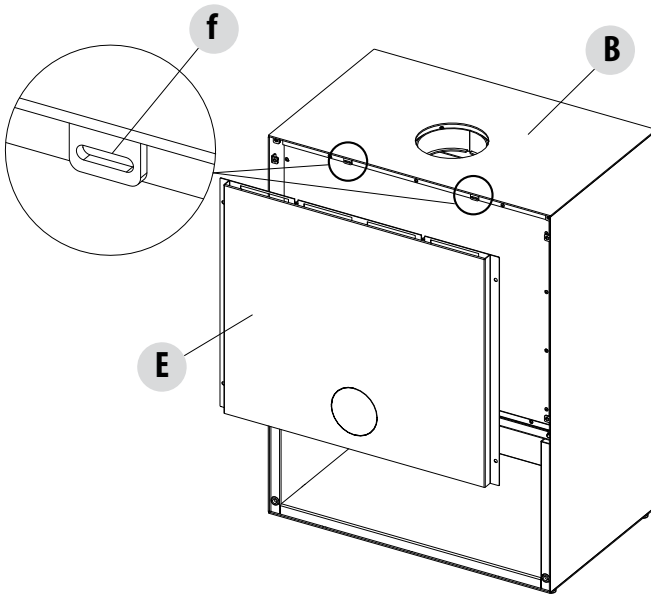

16-CLADDING ASSEMBLY PHASES

- Fasten back "E" to the structure using the 4 screws "y" supplied

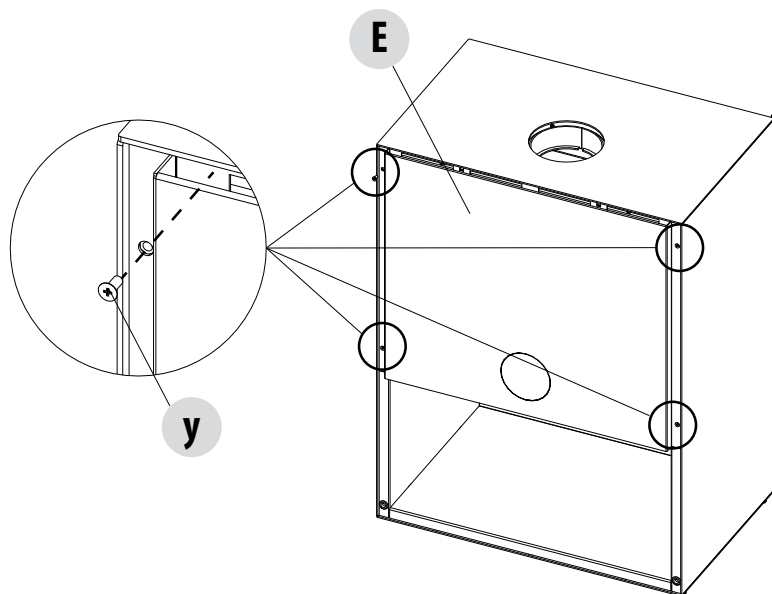

Take frame "F" and mount it on the frame

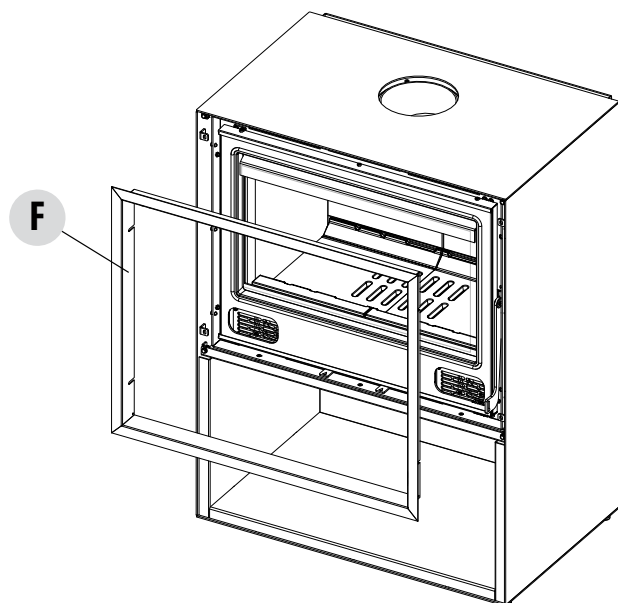

16-CLADDING ASSEMBLY PHASES

- Insert pegs “p” into holes “v”

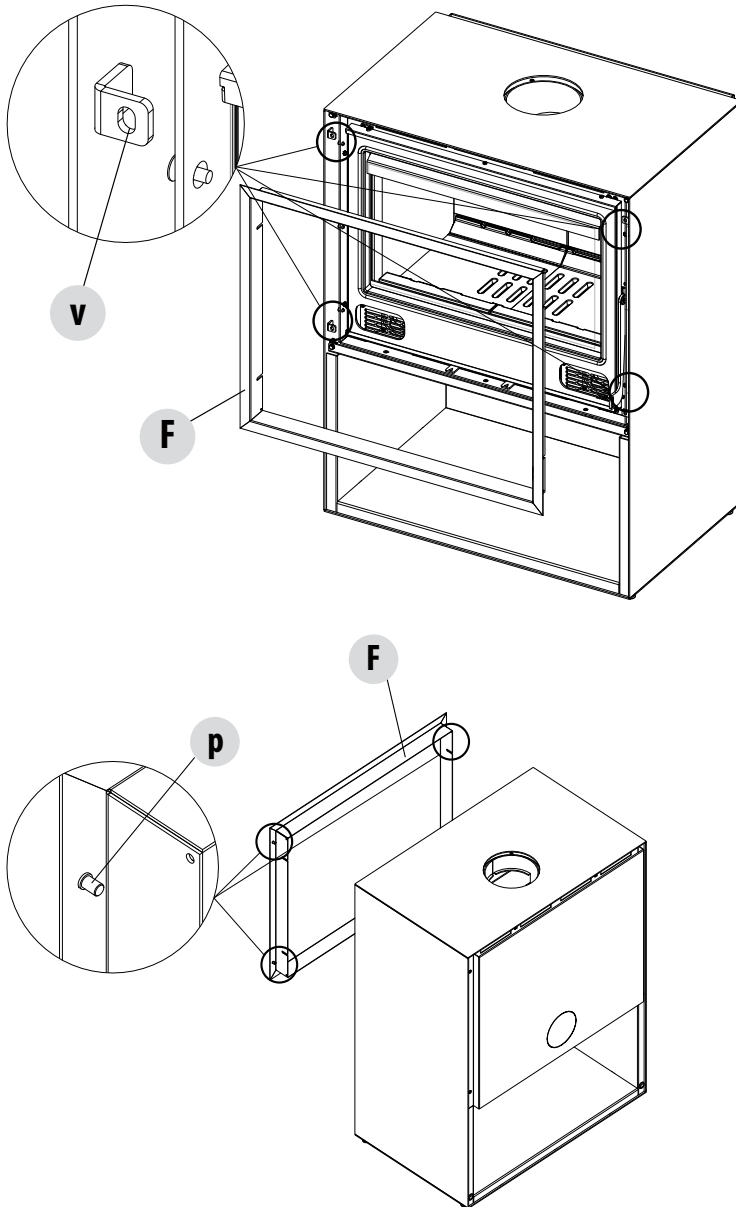

16-CLADDING ASSEMBLY PHASES

- Fasten frame "F" with the 4 screws "u"



CAUTION! When assembling/disassembling frame "F", take care that screw "u" and the glass of the firebox door do not come into contact. Glass breakage may occur.

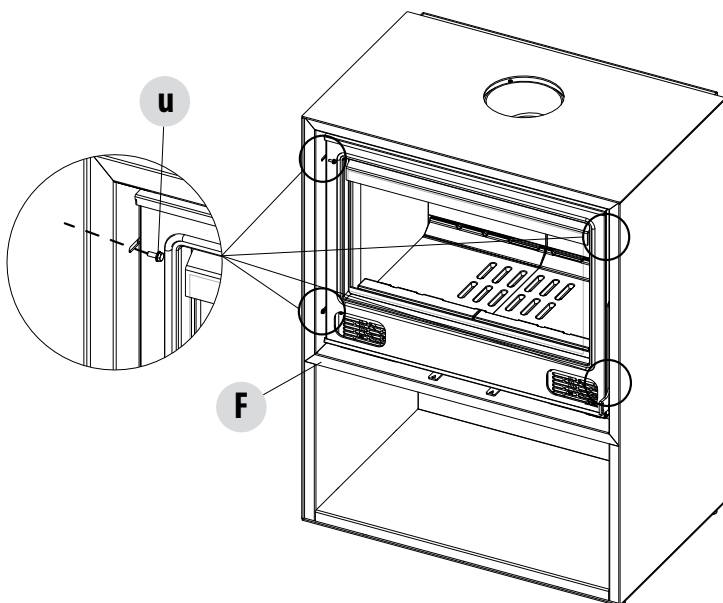

- Insert sleeve "H" and proceed with the smoke duct connections (optional - to be installed depending on the smoke outlet pipe to be used)

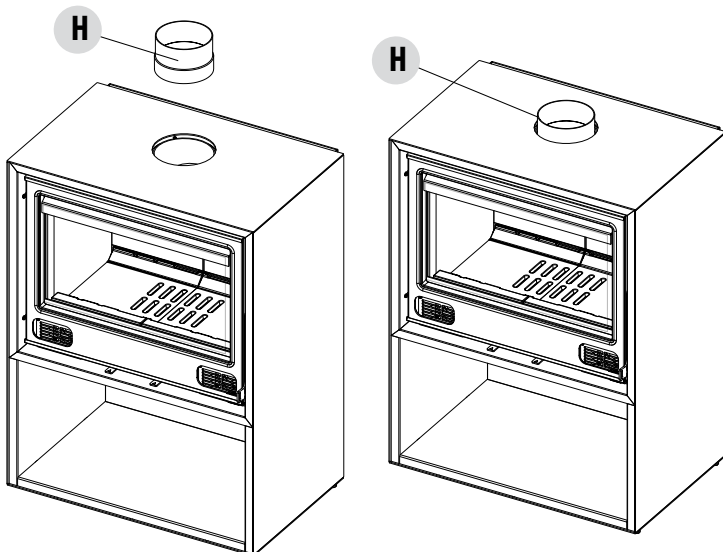

17-CHARACTERISTICS AND CLEANING

CUSTOM CLADDING MATERIAL CHARACTERISTICS

TECHNICAL SPECIFICATIONS	
Complies with the requirements of the European Union Regulation (EC) 1907/2006 concerning the Registration, Evaluation, Authorisation and Restriction of Chemicals (REACH).	
Water absorption ISO 10545-3:	≤ 0.3%
Breaking force in N (sample 200x300 mm) ISO 10545-4:	average value 700
Flexural strength in N/mm ² (sample 200x300 mm) ISO 10545-4:	average value 90
UNIEN101 Mohs scale hardness:	class 5 to 7
Deep abrasion resistance ISO 10545-6:	≤ 175 mm ³
Coefficient of linear thermal expansion 10-6/°C:	average value 6,6
Resistance to thermal shock ISO 10545-9:	resists
Chemical resistance ISO 10545-13:	class A to B
Stain resistance ISO 10545-14:	class 4 to 5
Frost resistance ISO 10545-12:	resists
Reaction to fire EN 13501:	A2 - s1, d0
Release of toxic/harmful substances ISO 10545-15:	No release

CLEANING THE CLADDING

CLEANING THE METAL PARTS

Below are a few indications to clean the metal cladding of the stove:

- use only water, if necessary with the addition of neutral detergents (pH7) and characterised by light additives.
- use only water on a cloth. There are electrical parts that could be damaged.
- use soft, non-abrasive cloths. Do not rub the surfaces.
- do not use solvents, abrasive or scratching agents. Do not use prepared compounds for cleaning paints as they could be aggressive.

CLEANING “MATERIA” STONEWARE

Below are a few indications to clean the “MATERIA” cladding:

- to remove dust wipe with a clean, dry cloth
- then use neutral detergents suitable for delicate surfaces
- do not use abrasive cloths to avoid rubbing the surface
- do not use acids or aggressive chemicals such as bleach, ammonia or acid detergents as these products may cause colour fading or create permanent stains



MCZ GROUP S.p.A.

Via La Croce n°8

33074 Vigonovo di Fontanafredda (PN) – ITALY

Telephone: 0434/599599 a.s.

Fax: 0434/599598

Website: www.mcz.it

e-mail: mcz@mcz.it